

# 2. Acute Mental Health Inpatient Unit for Children (16 Bed)

## Functional Relationships

### General issues

The functional diagrams shown below relate to the sub-units established in the Room Data Sheets. These generic conditions of relationship have been diagrammatically displayed for ease of communication. Specific interrelationships have not been shown.

## Functional Diagram

- 1 Admissions**
- 2 Consulting/Allied Health**
- 3 Nursing Staff**
- 4 Specialist Areas**
- 5 Consumer Areas**
- 7 Staff Facilities**
- 8 Hotel Services**

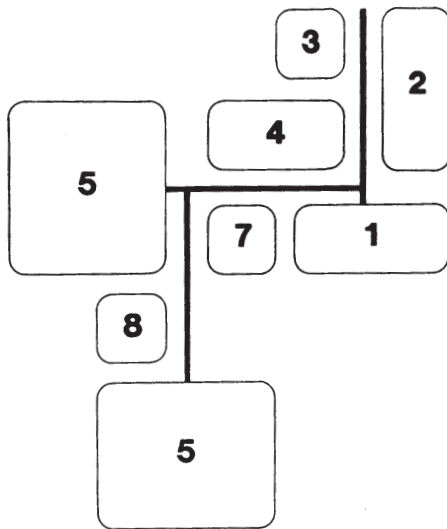

## Room Legend

The following spaces and rooms are included in the generic design.

- |  |  |
|--|--|
| <ul style="list-style-type: none"> <li><b>1 Admissions Sub-unit</b></li> <li>1.2 Interview Room</li> <li>1.3 Examination Room</li> <li>1.4 Entrance</li> <li>1.6 Waiting</li> <li>1.7 Visitors Toilet</li> </ul> <hr/> <ul style="list-style-type: none"> <li><b>2 Consulting/Allied Health Sub-unit</b></li> <li>2.1 Director's Office</li> <li>2.3 Registrar's Office</li> <li>2.5 Psychologist</li> <li>2.6 Occupational Therapist</li> <li>2.7 Social Worker</li> <li>2.8 Administrative Staff</li> </ul> <hr/> <ul style="list-style-type: none"> <li><b>3 Nursing Staff Sub-unit</b></li> <li>3.1 Nursing Manager</li> <li>3.2 Nurses' Office</li> </ul> <hr/> <ul style="list-style-type: none"> <li><b>4 Specialist Areas Sub-unit</b></li> <li>4.1 Consulting Room</li> <li>4.2 Group Room/Observation</li> <li>4.3 Group/Interview Room</li> </ul> | <ul style="list-style-type: none"> <li><b>5 Consumer Areas Sub-unit</b></li> <li>5.1 Single Bedroom</li> <li>5.2 Double Bedroom</li> <li>5.3 Special Purpose Bedroom</li> <li>5.4 Bathroom</li> <li>5.5 Kitchen</li> <li>5.7 Main Lounge</li> <li>5.8 Music Lounge/Night Lounge</li> <li>5.9 Quiet Lounge</li> <li>5.10 Activities Room</li> <li>5.11 Dining Room</li> <li>5.12 Laundry</li> <li>5.13 Treatment Room</li> </ul> <hr/> <ul style="list-style-type: none"> <li><b>7 Staff Facilities Sub-unit</b></li> <li>7.1 Nurses' Station</li> <li>7.2 Staff Lunch Room/Lounge</li> <li>7.3 Staff Toilets/Change Room</li> <li>7.4 Clean Utility Room</li> <li>7.5 Dirty Utility Room</li> <li>7.6 Medical Store</li> </ul> <hr/> <ul style="list-style-type: none"> <li><b>8 Hotel Services Sub-unit</b></li> <li>8.2 Clean Linen Store</li> <li>8.3 Soiled Linen Store</li> <li>8.4 Store (Patients' Effects)</li> <li>8.5 Store (General)</li> <li>8.6 Cleaner's Room</li> </ul> |
|--|--|

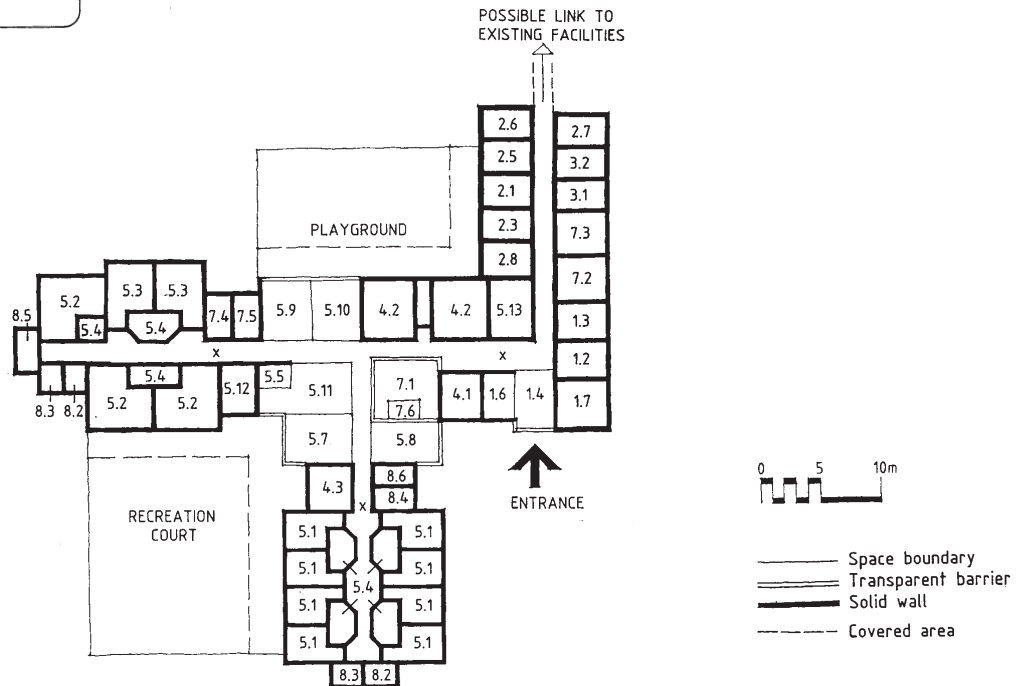

## Generic Layout Considerations

### General issues

The diagrammatic plan shows the significant space relationships for this facility. These have been scaled for ease of reference. They do not represent a preferred layout but one possibility of several acceptable layouts.

Building Guidelines for  
Queensland Mental Health Facilities

2

**Section 3** Design Guidelines

# 2. Acute Mental Health Inpatient Unit for Children (16 Bed)

## Introduction

### How to use this document

This guideline is intended to provide general information about this facility to potential designers, managers, service providers and others. This section should be read in conjunction with the General Principles (Section 2) and the Room Data Sheets (Section 4). The design information contained herein is generic and hypothetical. Readers should be aware of the implications of site requirements, budgets, management needs and the particular requirements of the service providers and consumers for a particular project.

The paragraphs included below contain information which is divergent from that contained in other parts of the general document. Where reference is made to individual space types or rooms, this information can be found in the Room Data Sheets. For more general objectives refer to the General Principles. Special and more specific information relating to this facility is listed below.

### Facility type description

This facility provides accommodation for an Acute Inpatient Unit for children. The building is primarily a health treatment building but incorporates other ancillary uses. It includes areas for public use, admission and offices, care areas, consumers' residential areas, staff facilities, hotel services and utility spaces. Provision should be made for carparks, private courtyards and delivery areas.

### Facility usage

This facility caters for the use by consumers of the service, the service providers including nursing, medical and allied health professionals, non-government organisations, Queensland Health employees and other management service providers, hotel services, students, research visitors and the general public. Restrictions in access to the facility will apply to some of these users but the facility will be fully operational 24 hours a day all year round.

There will be generally three shifts per day for service providers and some support services. There is an expected provision for emergency services, including service providers and other services such as police and ambulance, to be on hand at the required times. The general public, management, hotel and other ancillary services will most likely be restricted to day and evening use.

The administration of care involves procedures which have some similarities with general hospital care, e.g. admission, examination, allocation of residential accommodation and the provision of services needed to maintain consumers' stay in the unit. In addition, there is a significant need for direct observation of consumer areas, especially in activity, living and dining areas and external spaces. Nurses' stations are the hub of most observation configurations but there is a requirement that care is also available in all spaces used by consumers and that the designs do not encourage passive observation. Consumer spaces should reflect a variety of activities and offer numerous areas for individual respite, while still providing for care interaction.

### Building design philosophy and general intent

This building should be designed to maximise the dignity of consumers while establishing appropriate levels of professional care, and a therapeutic environment. The design should promote accessibility to all sections of society through the process of consultative design and by attention to environmental design processes, to produce equitable, comprehensible and sustainable buildings.

The facility will:

- Provide short-term treatment and relief of symptoms for children aged 13 years and under, who present with acute episodes of mental illness.
- Provide a safe and therapeutic environment for return of health sufficient to enable the child to return to their family and the community with appropriate support.
- Provide spaces for the administration of medication and psychological and social approaches to managing symptoms and for the education of the consumer, family and carers about the illness and recovery.
- Allow implementation of management strategies appropriate to the level of behavioural disturbance.
- Provide space for play and recreation.
- Provide counselling spaces for consumers, families and carers.
- Provide facilities to ensure continuity of care in case management models. This will involve liaison between inpatient and community or other services, both at pre- and post-admission and at discharge planning.

- Provide space for families and carers to participate in treatment or visit for long term periods.
- Provide for specific groups such as ASTI and non english speaking background.

Economic sustainability of capital works and recurrent funding for mental health facilities place the onus on designers to provide efficiency in circulation and economy of functional areas. A fine balance between efficient design, longevity and low maintenance buildings, optimum bed numbers, optimum clinical staffing of care providers and effective Personnel and support services management will provide a "best model" facility.

## Staffing Profile

### General issues

The administration of care in this type of facility requires a model that involves nursing professionals at the centre of continuous care, with ongoing consultant support from medical officers, visiting psychiatrists, psychologists, social workers and occupational therapists and with administrative support from clerical and management staff. Hotel services can be provided in the form of Queensland Health hotel services or as off-site contract provisions. Support from outside the service may be provided by non-government organisations, or informal public or family support. A large proportion of those using the facility will be visiting for limited times, generally during day and evening periods.

### Schedule of user types

The following table gives an example of a mix of staff typical for this facility and is provided to establish a notional maximum number expected to be in the facility on the busiest shift.

User group	Maximum FTE for any single shift
Nursing	6
Allied Health	3
Medical	3
Administration	1
Support	3
TOTAL	16

## General Design Principles

The following are special requirements in addition to the General Principles (Section 2).

### Siting and site selection

- Preferably sited as a single-storey building co-located with or adjacent to a child health facility as part of a general hospital campus.
- Sited adjacent to a lightly trafficked road or street and to landscaped parkland or other outlook.

### Site layout

Preferably located on a single level on ground, although the unit may be located on upper levels if outdoor space can be safely provided by enclosed roof courts.

### Landscape treatments

Provision of play space with play equipment is required in adjacent outdoor spaces.

### Security and privacy

Children's recreation areas should have defined separate courtyard areas with more attention to outdoor play and continuous observation by carers.

### Interior Design

Interior design should attend to variety and separate identity within separately defined living spaces. Living spaces should be of a scale and definition so as to reflect a child-appropriate feel or ambience.

### Interior fixtures and fitments

Fixtures and fitments should be child-proof where access would provide hazard or danger to children.

### Signage and art

Signage and art should reflect children's themes and use illustrative icons rather than text.

## Schedule of Functional Areas

No.	Function Name	Req	m <sup>2</sup> (min.)	Total	Remarks
1.0	Admissions			68	Sub Unit
1.2	Interview Room	1	12	12	
1.3	Examination Room	1	10	10	For 2 FTE+2m <sup>2</sup> /FTE > 2
1.4	Entrance	1	15	15	+5m <sup>2</sup> outside area
1.6	Waiting	1	15	15	For 8 users+2m <sup>2</sup> /user >8
1.7	Visitors Toilets	2	8	16	For 1 sex and disabled
2.0	Consulting/Allied Health			70	Sub Unit
2.1	Director's Office	1	12	12	
2.3	Registrar's Office	1	12	12	
2.5	Psychologist	1	12	12	
2.6	Occupational Therapist	1	12	12	
2.7	Social Worker	1	12	12	
2.8	Administrative Staff	1	10	10	For 1 FTE+5m <sup>2</sup> /FTE > 1
3.0	Nursing Staff			20	Sub Unit
3.1	Nursing Manager	1	10	10	For 2 FTE+5m <sup>2</sup> /FTE > 2
3.2	Nurses' Office	1	10	10	
4.0	Specialist Area			62	Sub Unit
4.1	Consulting Room	1	10	10	For 2 users
4.2	Group Room/ Observation	2	20	40	For 6 users : 15 max.
4.3	Group/Interview Room	1	12	12	For 3 users
5.0	Consumer Areas			366.5	Sub Unit
5.1	Single Bedroom	8	12	96	
5.2	Double Room	3	20	60	
5.3	Special Purpose Bedroom	2	15	30	For consumer and related person
5.4	Bathroom	13	5.5	71.5	1 to 2 users each
5.5	Kitchen	1	10	10	Accessible to consumers
5.7	Main Lounge	1	15	15	+1m <sup>2</sup> /bed
5.8	Music Lounge/ Night Lounge	1	10+5	15	+1m <sup>2</sup> /bed
5.9	Quiet Lounge	1	15	15	
5.10	Activities Room	1	15	15	+1m <sup>2</sup> /bed
5.11	Dining Room	1	15+5	20	+1m <sup>2</sup> /bed (20 consumers max.)
5.12	Laundry	1	5+2	7	+0.2m <sup>2</sup> /bed
5.13	Treatment Room	1	12	12	

No.	Function Name	Req	m <sup>2</sup> (min.)	Total	Remarks
7.0	Staff Facilities			77	Sub Unit
7.1	Nurses' Station	1	15+10	25	For 2 FTE+2.5m <sup>2</sup> /FTE >2
7.2	Staff Lunch Room/ Lounge	1	15	15	12 users
7.3	Staff Toilets/ Change Room	1	15	15	Male and female
7.4	Clean Utility Room	1	8	8	+0.25m <sup>2</sup> /bed > 10
7.5	Dirty Utility Room	1	8	8	+0.25m <sup>2</sup> /bed > 10
7.6	Medical Store	1	6	6	
8.0	Hotel Services			31	Sub Unit
8.2	Clean Linen Store	2	4	8	+0.2m <sup>2</sup> /bed
8.3	Soiled Linen Store	2	4	8	+0.2m <sup>2</sup> /bed
8.4	Store (Patients' Effects)	1	2+3	5	+0.2m <sup>2</sup> /bed
8.5	Store (General)	1	4+1	5	+0.2m <sup>2</sup> /bed
8.6	Cleaner's Room	1	4+1	5	
	Sub-total			695	
	Circulation, Storage and Misc. @25%			174	
	Carparking for 10 Cars (2 disabled)				+0.5/bed; 0.1/disabled; 0.1/visitors
	TOTAL			869	

## Particular Space Considerations

### General issues

This facility will most likely be built on an existing general hospital campus. The nature of the facility care and proximity may allow the common use of support services, school rooms and other facilities.

### Specific space management requirements

Where allied health and consulting medical services can be provided from established community mental health centres in close proximity, some office spaces from this sub-unit may be reduced or deleted.

There may be more demand for family access and for parent sleeping accommodation than for more generic units.

It is more likely that children can share bedroom accommodation than adults or youths.

Please attach your list of specific requirements behind this document.