

## Dental Laboratories

---

### Function

---

Dental laboratories provide support activities associated with dental surgeries. Laboratory activities primarily involve the fabrication of various prosthetic appliances. Laboratories generally consist of 8 separate functional areas. These are:

- ▶ Barrier Area
- ▶ Laboratory Administration
- ▶ Preparation Area
- ▶ Dental Technicians Workspace
- ▶ Ceramics Area
- ▶ Plaster and Packing Area
- ▶ Casting Area
- ▶ Polishing Area
- ▶ Clean Area

Chrome work is a major component of the laboratory work and the specialised equipment used for investing and polishing needs to be accommodated either in a separate area or within the Polishing Room.

Crown and Bridge work can be performed in a separate, dedicated Laboratory; otherwise it may be integrated in the Dental Laboratory, only if a separate Ceramic Room is provided.

---

### Design Options

---

#### *Single Room*

Single room design incorporates two compartments which keep separate dirty and clean areas. Incorporated in the design are a barrier area for adjustment, pouring up area, plaster and packing area, technician's workspace, polishing area, clean area for dispatch, and administration workshop. The single room design will accommodate a single technician and is appropriate for small to medium sized facilities.

#### *Multi Room*

The multi room design accommodates individual work areas into separate rooms. This design is appropriate for larger facilities which undertake laboratory work for satellite clinics.

#### *External*

Prosthetic work may sometimes be outsourced. In this case, the minimum accommodation requirement for oral health facilities is a Barrier Room for decontamination and an adjoining small Laboratory for plaster and wax work. Small adjustment of prosthetics can be made in the surgery.

---

### General Standard

---

- ▶ AS/NZS 2982.1:1997 Laboratory design and construction Part 1: General Requirements.
- ▶ AS/NZS 2243.1:1997 Safety in Laboratories Part 1: General
- ▶ AS/NZS 2243.10:1993 Safety in Laboratories Part 10: Storage of chemicals

---

## Location

---

The Laboratory is located close to the dental surgeries with direct access to the main circulation corridor. In the case of a multi-room arrangement, the Barrier and Clean Areas are positioned as separate rooms adjacent the dental laboratory with access to the circulation corridor.

The Clean Room also has direct access to the Laboratory.

---

## Workflow

---

### *Barrier Area*

All incoming work from the dental surgeries is decontaminated in the Barrier Area before entering the Laboratory. This is a dirty workspace and does not have direct access to the laboratory. The work is decontaminated with detergent, disinfected in a bath of Milton solution, rinsed and then passed through a connecting window into the adjoining Laboratory Administration area. This area may also be used by the dentist to make adjustments to the appliance at the try-in stage when the patient is being fitted with a wax prototype of the denture.

### *Laboratory Administration*

This is a clean area where the decontaminated work, passed from the Barrier Area, is registered on a computer, labelled and assigned to colour coded storage bins, e.g. maxi-bin storage system. The storage system allows the work to be arranged in various stages with the completion dates required for each stage. The work is held in the storage bins until it is ready to be processed in the Dental Technicians Workspace. The Laboratory Administration area is generally an extension of the Dental Technicians Workspace.

In larger facilities, a separate office is also required for the Senior Dental Technician to carry out administrative duties.

### *Preparation Area*

This is a wet area where a plaster model of the patient's upper and/ or lower jaw is poured from the preliminary impression taken by the dentist. Afterwards, a Stone model is cast from the final impression taken by the dentist using an acrylic impression tray, which is created from the previous plaster model. After the models are poured and set, they are trimmed using a model grinder. In smaller facilities, where space is limited, the function of the Preparation Area can be incorporated with Plaster and Packing.

### *Dental Technicians Workspace*

This workspace is the core of the Laboratory where dental technicians carry out a variety of work processes, such as:

- ▶ preparing cases for packing or polishing
- ▶ trimming and grinding using micro-motor (handpiece)
- ▶ making trays
- ▶ waxing up procedures e.g. wax rims
- ▶ setting up teeth for try-ins
- ▶ wire bending
- ▶ repairs to dentures
- ▶ chrome work

The technicians work at individual, ergonomic, height adjustable workbenches which are fitted with extraction units, compressed air, gas for bunsen burners, micro-motor handpieces and task lighting. Additional bench space is required for bench-mounted equipment, such as soldering irons, light-curing machines, a vacuum former (for making mouthguards), cast surveyors and pressure pots for cold curing process (used for small denture work). Storage cupboards, shelving, tooth cabinet, hand-wash basin and an eyewash station are also required to be incorporated into the workspace.

The workspace is positioned to have direct access to all other laboratory functions, other than the Barrier and Preparation Areas.

#### *Ceramics Area*

This is a separate, enclosed clean area located adjacent the Dental Technicians Workspace, where technicians carry out the layering, vacuum firing and finishing of ceramic crowns, bridges, porcelain veneers and other ceramic appliances.

The room must be a dust-free environment with good natural lighting for ceramic work with colour corrected lighting for matching porcelain colours. The technicians work at individual ergonomic, height adjustable workbenches which are fitted with extraction units, compressed air, gas for bunsen burners, micro-motors, task lighting and bench space at each workstation for a vacuum furnace.

#### *Plaster and Packing Area*

This area is located adjacent the Dental Technicians Workspace and is used for the investing and processing of dentures. After the patient has been satisfactorily fitted with the wax denture at the try-in stage, it is then returned to the laboratory where it is used to fabricate the final prosthesis. The wax denture is set into the bottom section of the flask, which has been filled with plaster to form a cast. Once the top section of the flask is fitted over the bottom section, dental stone mix is then poured into the assembled flask, covering (investing) the cast and denture until the cavity of the flask is completely filled. The flask is then closed with a lid, clamped, and the investment left to set. After setting and the clamp removed, the flask is put into a hot water bath to soften the wax denture. After the bath, the flask is opened up into the two sections and the softened wax is washed away from the stone mould and teeth. A separating medium is applied to the stone mould in each flask section before it is packed with prepared acrylic mix. After packing with acrylic, the flask is reassembled, pressed in a flask press, clamped, and then taken into the Casting Room where it is placed in a boiling water urn for heat processing.

#### *Casting Room*

This area is located adjacent the Plaster and Packing Area. It is a hot area used for the heat processing of dentures and for fabricating metal castings used for substructures, crowns and bridges. In addition to the boiling water urns (acrylisers), other equipment in the Casting Area includes burn-out furnace (for wax elimination process), centrifugal casting machine and sandblasting machine (for removing investment material from the casting).

#### *Polishing Area*

This area is located adjacent the Dental Technicians Workspace and is used for the polishing and trimming of acrylic and chrome dentures. The investing of chrome work can also be carried out in this room. This is a noisy area and acoustic control measures are required.

#### *Clean Area*

This is ideally a room located adjacent the Dental Technicians Workspace and is used for decontaminating all completed work. The work is decontaminated with detergent, disinfected in a bath of Milton solution, rinsed, bagged in plastic and then placed in maxi-bins, wall-mounted within the room, ready for collection. If space is an issue, then the Clean Area can simply be reduced to an alcove, with bench and sinks for decontaminating and rinsing, positioned close to the Laboratory entry/exit point.

---

## Construction and Finishes

---

### *Walls*

Wall surfaces should be smooth, impervious and easy to clean. Protect walls above sinks with splashbacks.

### *Ceilings*

Provide flush-set, smooth and easy to clean ceilings in the Barrier Laboratory and Clean Room. Use acoustic ceilings elsewhere.

### *Floors*

Finish floors with vinyl sheeting, coved at walls. Use non-slip vinyl in wet areas.

### *Work surfaces*

Work benches should be durable and constructed of non-porous material with integral splashbacks at walls for easy cleaning. Stainless steel is desirable in high use areas.

### *Doors*

Provide adequately sized doors with viewing panels.

### *Windows*

Provide internal viewing panels in walls separating the various functions of the Laboratory.

---

## Services and Environment

---

Services and environment control in laboratory areas should include:

- ▶ General comfort air conditioning to the laboratory areas.
- ▶ A centralised dust extraction and collection system complete with vacuum pump, filtration media, dust collection reservoirs, and exhaust points.
- ▶ Specific exhaust ventilation systems for the casting room, crown and bridge laboratory, and plaster and packing room.
- ▶ Fume exhaust systems comprising fume cupboard, ducted exhaust and exhaust fan are to be provided where nominated in each of these spaces.
- ▶ Smoke detectors located with consideration to dust, gas and heat production so as to avoid false alarms.
- ▶ General exhaust ventilation systems as required throughout the entire laboratory area.
- ▶ Bench-mounted compressed air and town gas adjacent each workstation throughout the laboratory area.
- ▶ Good task lighting at every workstation. It is essential that colour corrected lighting be provided in the Ceramics Room.
- ▶ Plaster traps to sinks in all rooms other than the Clean Room.
- ▶ A wax trap fitted to the sink used for washing out wax, in the Plaster and Packing Room.

## Single Room Dental Laboratory

### Room Data Sheet

Functional Information	
<b>Functions:</b>	Workspace for construction of prosthetic appliances and waxing up procedures. The room, divided into two compartments, incorporates the following functions: Barrier area for adjustment, pouring up area, plaster and packing area, technician's workspace, polishing area, clean area for dispatch and admin. workstation.
<b>Relationship:</b>	Locate adjacent surgeries.
<b>Floor Area:</b>	28m <sup>2</sup>
<b>Occupants:</b>	Patients: N/A      Staff: 1      Visitors: N/A
<b>Time of Use:</b>	
Construction and Finishes	
<b>Floors:</b>	Non-slip vinyl sheeting to wet areas with vinyl sheeting elsewhere. <b>Skirtings:</b> Vinyl covered 150mm high
<b>Walls:</b>	Painted flush-set plasterboard linings.
<b>Ceiling:</b>	Acoustic tiles. <b>Height:</b> 2700
<b>Doors:</b>	Solid core with half glass viewing panel
<b>Door Hardware:</b>	Lockable with free handle exit, door stop.
<b>Windows:</b>	Viewing panel into circulation corridor.
<b>Signage:</b>	Room identification.
Services and Environment	
<b>Lighting:</b>	Fluorescent with task lighting.
<b>Power:</b>	GPO's as required
<b>Communications:</b>	Wall mounted telephone / intercom. Data outlets for computer.
<b>Gases:</b>	Natural gas, compressed air and suction (vacuum).
<b>Sanitary Fixtures:</b>	Stainless steel sinks with plaster traps. Boiling water unit. Hand basin and eyewash.
<b>Environmental Control:</b>	Air conditioning with specific exhaust ventilation systems and specific dust extraction and collection system.
<b>Acoustics:</b>	Acoustic ceiling.
Furniture and Equipment	
<b>Loose Furniture:</b>	Ergonomic operator's chair, adjustable with footrest.
<b>Built In Furniture:</b>	Stainless steel bench unit with underbench cupboards and space for plaster and stone trolleys. Exhaust hood over boiling out area. Adjustable wall shelving. Ergonomic workstation, height adjustable with waste drawer, underbench drawers & built-in extraction system. Bench units for equipment. Tooth cupboard.
<b>Equipment / Fittings:</b>	Micro-motor handpieces, model grinder, lathe, press, compressed air gun, acrylic injection unit, cold curing unit, vacuum mixer, acryliser, polishing machine, fume cupboard and bunsen burners. Soap dispenser Paper towel dispenser Glove dispenser

Indicative Plan

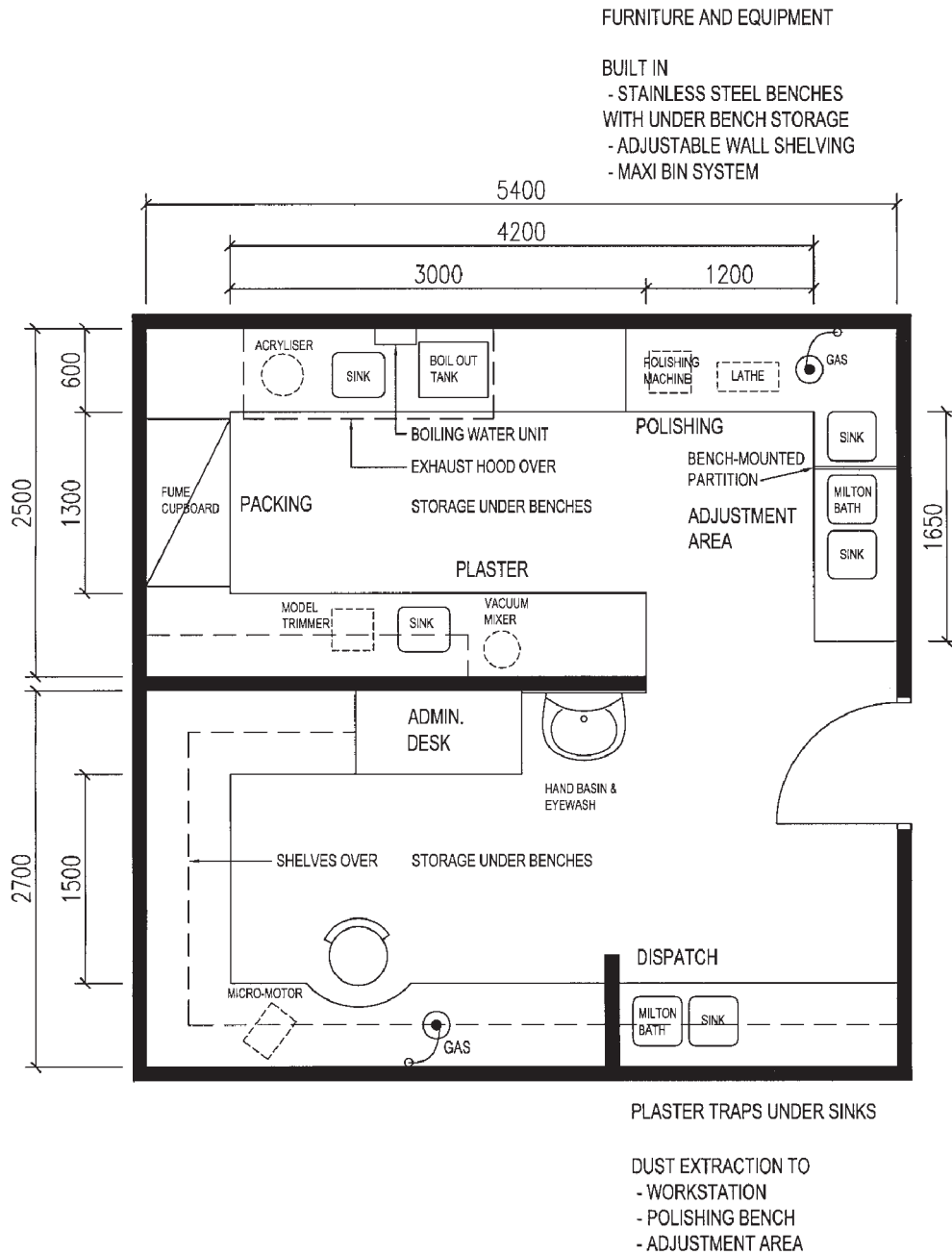

LEGEND	
HB .....	HAND BASIN
S.....	SINK
C .....	CRYLISER
WH .....	WATER HEATER
LM .....	LABORATORY MOTOR
CS.....	COLD STERILIZING
MT.....	MODEL TRIMMER
WM.....	WHIP MIX

## Multi Room Dental Laboratory

### Room Data Sheet – Barrier Room

Functional Information	
<b>Functions:</b>	Dirty area which receives incoming work for decontamination. Work is decontaminated in Milton Bath, rinsed and then passed through to the Laboratory Administration area for registering, labelling and assignment.
<b>Relationship:</b>	Direct access to circulation corridor. Locate adjacent Laboratory Administration with pass-through window access.
<b>Floor Area:</b>	7 m <sup>2</sup>
<b>Occupants:</b>	Patients: N/A      Staff: Up to 2      Visitors: N/A
<b>Time of Use:</b>	Business hours (8.00am to 5.00pm)
Construction and Finishes	
<b>Floors:</b>	Use non-slip vinyl sheeting      Skirtings: Vinyl covered 150mm high.
<b>Walls:</b>	Painted flush-set plasterboard linings.
<b>Ceiling:</b>	Painted flush-set plasterboard linings.      Height: 2700
<b>Doors:</b>	Solid core with half glass viewing pane.
<b>Door Hardware:</b>	Passage set.
<b>Windows:</b>	Provide viewing panel into adjoining rooms. Provide pass-through window into Laboratory Administration to transfer decontaminated work.
<b>Signage:</b>	Room identification.
Services and Environment	
<b>Lighting:</b>	Fluorescent.
<b>Power:</b>	GPO's as required.
<b>Communications:</b>	Telephone / intercom.
<b>Gases:</b>	Compressed air.
<b>Sanitary Fixtures:</b>	Stainless steel sinks, one with retractable hand held spray nozzle for rinsing. Milton bath for decontamination.
<b>Environmental Control:</b>	Air conditioning.
<b>Acoustics:</b>	N/A
Furniture and Equipment	
<b>Loose Furniture:</b>	Waste bin
<b>Built In Furniture:</b>	Stainless steel bench unit with storage cupboards and drawer unit under. Adjustable wall shelving.
<b>Equipment / Fittings:</b>	Lathes. Soap dispensers. Paper towel dispensers. Glove dispensers.

## Room Data Sheet – Administration Area

Functional Information	
<b>Functions:</b>	Clean area where all incoming work is documented, labelled and assigned to coloured coded storage bins.
<b>Relationship:</b>	Locate adjacent Barrier Laboratory. Access to Dental Technicians Workspace.
<b>Floor Area:</b>	11 m <sup>2</sup>
<b>Occupants:</b>	Patients: N/A      Staff: 1      Visitors: N/A
<b>Time of Use:</b>	Business hours (8.00am to 5.00pm)
Construction and Finishes	
<b>Floors:</b>	Sheet vinyl      Skirtings: Vinyl covered 150
<b>Walls:</b>	Flush plasterboard.
<b>Ceiling:</b>	Flush plasterboard      Height: 2700
<b>Doors:</b>	N/A
<b>Door Hardware:</b>	N/A
<b>Windows:</b>	Provide pass-through window from Barrier Laboratory.
<b>Signage:</b>	Room identification.
Services and Environment	
<b>Lighting:</b>	Fluorescent.
<b>Power:</b>	GPO's as required.
<b>Communications:</b>	Telephone / intercom. Data outlet.
<b>Gases:</b>	N/A
<b>Sanitary Fixtures:</b>	N/A
<b>Environmental Control:</b>	Air conditioning.
<b>Acoustics:</b>	N/A
Furniture and Equipment	
<b>Loose Furniture:</b>	Ergonomic clerical chair.
<b>Built In Furniture:</b>	Provide bench unit with computer workstation. Adjustable wall shelving.
<b>Equipment / Fittings:</b>	Computer. Printer. Maxi-bin storage system.

*Room Data Sheet – Senior Dental Technician’s Office*

Functional Information	
<b>Functions:</b>	An office for administration of the dental laboratory and for meeting sales representatives and ordering supplies.
<b>Relationship:</b>	Adjacent Laboratory Administration area and Dental Technician’s Workspace.
<b>Floor Area:</b>	1 <sup>2</sup> m <sup>2</sup>
<b>Occupants:</b>	Patients: N/A      Staff: 2      Visitors: 1 or 2
<b>Time of Use:</b>	Business hours (8.00am to 5.00pm)
Construction and Finishes	
<b>Floors:</b>	Sheet vinyl      Skirtings: Vinyl coved 150.
<b>Walls:</b>	13mm Plasterboard flush set.
<b>Ceiling:</b>	10mm Plasterboard flush set.      Height: 2700mm
<b>Doors:</b>	Solid core – half glass.
<b>Door Hardware:</b>	Lockable with free handle exit, door stop.
<b>Windows:</b>	Provide views into Dental Technician’s Workspace.
<b>Signage:</b>	Room identification.
Services and Environment	
<b>Lighting:</b>	Fluorescent.
<b>Power:</b>	GPOs as required.
<b>Communications:</b>	2 x telephone / intercom. 2 x Data outlets.
<b>Gases:</b>	N/A
<b>Sanitary Fixtures:</b>	N/A
<b>Environmental Control:</b>	Air conditioning.
<b>Acoustics:</b>	STC 35-40
Furniture and Equipment	
<b>Loose Furniture:</b>	Workstations with drawers. Filing cabinets (2). Chairs: office (2).
<b>Built In Furniture:</b>	Wall mounted shelves.
<b>Equipment / Fittings:</b>	White & pin boards. Computers. Bookshelves. Clock (battery).

## Room Data Sheet – Preparation Room

Functional Information	
Functions:	Wet area for pouring impressions and trimming models.
Relationship:	Locate adjacent Dental Technician's Workspace.
Floor Area:	6 m <sup>2</sup>
Occupants:	Patients: N/A      Staff: 1      Visitors: N/A
Time of Use:	Business hours (8.00am to 5.00pm).
Construction and Finishes	
Floors:	Non-slip vinyl sheeting.      Skirtings: Vinyl covered 150
Walls:	Flush set plasterboard.
Ceiling:	Flush set plasterboard.      Height: 2700
Doors:	Solid core with half glass viewing pane.
Door Hardware:	Lockable with free handle exit, door stop.
Windows:	Viewing panel into adjoining areas.
Signage:	Room identification.
Services and Environment	
Lighting:	Fluorescent.
Power:	GPO's as required.
Communications:	Wall mounted telephone / intercom.
Gases:	Natural gas and compressed air.
Sanitary Fixtures:	Stainless steel sink with plaster trap.
Environmental Control:	Air conditioned.
Acoustics:	Low echo
Furniture and Equipment	
Loose Furniture:	N/A
Built In Furniture:	Stainless steel bench unit with space for plaster and stone trolley under. Adjustable wall shelving.
Equipment / Fittings:	Model grinder. Vacuum mixer. Soap dispenser. Paper towel dispenser.

*Room Data Sheet – Dental Technicians’ Workspace*

Functional Information	
<b>Functions:</b>	Provide laboratory services to surgeries. Workspace for construction of prosthetic appliances and waxing up procedures.
<b>Relationship:</b>	Locate adjacent Plaster and Packing, Casting and Polishing Rooms.
<b>Floor Area:</b>	3.6 to 4.6 m <sup>2</sup> / technician.
<b>Occupants:</b>	Patients: N/A      Staff: Varies      Visitors: N/A
<b>Time of Use:</b>	Business hours (8.00am to 5.00pm).
Construction and Finishes	
<b>Floors:</b>	Sheet vinyl      Skirtings: Vinyl covered 150
<b>Walls:</b>	Flush plasterboard.
<b>Ceiling:</b>	Acoustic tiles.      Height: 2700
<b>Doors:</b>	Solid core with half glass viewing pane.
<b>Door Hardware:</b>	Lockable with free handle exit, door stop.
<b>Windows:</b>	Viewing panel into adjoining areas.
<b>Signage:</b>	N/A
Services and Environment	
<b>Lighting:</b>	Fluorescent with task lighting.
<b>Power:</b>	GPO’s as required.
<b>Communications:</b>	2 x wall hung telephones / intercom.
<b>Gases:</b>	Natural gas, compressed air and suction (vacuum).
<b>Sanitary Fixtures:</b>	Hand basin and eye wash.
<b>Environmental Control:</b>	Air conditioning and centralised dust extraction and collection system.
<b>Acoustics:</b>	Acoustic ceiling.
Furniture and Equipment	
<b>Loose Furniture:</b>	Ergonomic operator’s chairs, adjustable with footrests.
<b>Built In Furniture:</b>	Ergonomic workstations, height adjustable with waste drawers, underbench drawers & built-in extraction system. Bench units for equipment. Tooth cupboard.
<b>Equipment / Fittings:</b>	Micro-motor handpieces and bunsen burners, Surveyor, soldering units, compressed air guns, pressure forming units and cold curing units. Soap dispenser Paper towel dispenser

## Room Data Sheet – Ceramics Room

Functional Information	
<b>Functions:</b>	Separate enclosed clean area for the layering, burning and finishing of ceramic crowns, bridges etc.
<b>Relationship:</b>	Locate adjacent Dental Technicians Workspace.
<b>Floor Area:</b>	16m <sup>2</sup> (includes 3 workbenches)
<b>Occupants:</b>	Patients: N/A      Staff: Varies      Visitors: N/A
<b>Time of Use:</b>	Business hours (8.00am to 5.00pm).
Construction and Finishes	
<b>Floors:</b>	Sheet vinyl      Skirtings: Vinyl covered 150
<b>Walls:</b>	Flush plasterboard.
<b>Ceiling:</b>	Acoustic tiles.      Height: 2700
<b>Doors:</b>	Solid core – half glass.
<b>Door Hardware:</b>	Lockable with free handle exit, door stop.
<b>Windows:</b>	Provide view into adjoining areas.
<b>Signage:</b>	
Services and Environment	
<b>Lighting:</b>	Fluorescent with task lighting. Colour corrected lighting is essential.
<b>Power:</b>	GPO's as required.
<b>Communications:</b>	1 x wall mounted telephone / intercom.
<b>Gases:</b>	Natural gas, compressed air and suction (vacuum).
<b>Sanitary Fixtures:</b>	SS sink drainer one side.
<b>Environmental Control:</b>	Air conditioning and centralised dust extraction and collection system.
<b>Acoustics:</b>	Acoustic ceiling.
Furniture and Equipment	
<b>Loose Furniture:</b>	Ergonomic operator's chairs, adjustable with footrests.
<b>Built In Furniture:</b>	Ergonomic workstations, height adjustable with waste drawers, underbench drawers & built-in extraction system. Bench unit for equipment with underbench cupboards and one bank of drawers. Storage cupboards, wall mounted above bench unit.
<b>Equipment / Fittings:</b>	Micro-motor handpieces. Bunsen burners. Vacuum furnaces (one per workstation). Ultra-sonic cleaner. Steam cleaner (wall mounted). Soap dispenser. Paper towel dispenser.

## Room Data Sheet – Plaster and Packing Area

Functional Information					
<b>Functions:</b>	Investing and processing dentures.				
<b>Relationship:</b>	Locate adjacent Dental Technician's Workspace.				
<b>Floor Area:</b>	3 <sup>2</sup> m <sup>2</sup>				
<b>Occupants:</b>	Patients:	N/A	Staff:	Varies	Visitors: N/A
<b>Time of Use:</b>	Business hours (8.00am to 5.00pm).				
Construction and Finishes					
<b>Floors:</b>	Non-slip vinyl sheeting.			<b>Skirtings:</b>	Vinyl covered 150.
<b>Walls:</b>	Flush set plasterboard.				
<b>Ceiling:</b>	Acoustic.			<b>Height:</b>	2700
<b>Doors:</b>	Solid core with half glass viewing pane.				
<b>Door Hardware:</b>	Lockable with free handle exit, door stop.				
<b>Windows:</b>	Viewing panel into adjoining areas.				
<b>Signage:</b>	Room identification.				
Services and Environment					
<b>Lighting:</b>	Fluorescent.				
<b>Power:</b>	GPO's as required.				
<b>Communications:</b>	Wall mounted telephone / intercom.				
<b>Gases:</b>	Natural gas and compressed air.				
<b>Sanitary Fixtures:</b>	Stainless steel sinks with plaster traps. Boiling water unit.				
<b>Environmental Control:</b>	Air conditioning and specific exhaust ventilation systems.				
<b>Acoustics:</b>	Acoustic ceiling.				
Furniture and Equipment					
<b>Loose Furniture:</b>	N/A				
<b>Built In Furniture:</b>	Stainless steel bench unit with underbench cupboards and space for plaster and stone trolleys. Exhaust hood over boiling out area. Adjustable wall shelving.				
<b>Equipment / Fittings:</b>	Plaster and stone storage trolleys. Equipment: Grinders, warming tray, presses, ultrasonic cleaner, compressed air gun, acrylic injection unit, cold curing units and rubber mats. Fume cupboard Bunsen burner Soap dispenser Paper towel dispenser				

## Room Data Sheet – Casting Room

Functional Information	
<b>Functions:</b>	Hot room for the heat processing of dentures.
<b>Relationship:</b>	Locate adjacent Dental Technician's Workspace.
<b>Floor Area:</b>	8 m <sup>2</sup> minimum
<b>Occupants:</b>	Patients: N/A      Staff: Up to 2      Visitors: N/A
<b>Time of Use:</b>	Business hours (8.00am to 5.00pm).
Construction and Finishes	
<b>Floors:</b>	Non-slip vinyl sheeting.      Skirtings: Vinyl covered 150
<b>Walls:</b>	Flush set plasterboard.
<b>Ceiling:</b>	Acoustic      Height: 2700
<b>Doors:</b>	Solid core with half glass viewing panel.
<b>Door Hardware:</b>	Lockable with free handle exit, door stop.
<b>Windows:</b>	Viewing panel into adjoining areas.
<b>Signage:</b>	Room identification.
Services and Environment	
<b>Lighting:</b>	Fluorescent.
<b>Power:</b>	GPO's as required.
<b>Communications:</b>	Wall mounted telephone / intercom.
<b>Gases:</b>	Compressed air.
<b>Sanitary Fixtures:</b>	Stainless steel sink & bench unit with setdown for acrylisers.
<b>Environmental Control:</b>	Air conditioning and specific exhaust ventilation.
<b>Acoustics:</b>	Acoustic ceiling.
Furniture and Equipment	
<b>Loose Furniture:</b>	N/A
<b>Built In Furniture:</b>	Stainless steel sink & bench unit with setdown for acrylisers. Exhaust hood over acrylisers.
<b>Equipment / Fittings:</b>	Acrylisers Sandblaster Casting machine Burn-out furnace Soap dispenser Paper towel dispenser

*Room Data Sheet – Polishing Room*

Functional Information	
<b>Functions:</b>	Polishing and trimming of acrylic and chrome dentures.
<b>Relationship:</b>	Locate adjacent Dental Technician’s Workspace and Clean Room.
<b>Floor Area:</b>	11 m <sup>2</sup>
<b>Occupants:</b>	Patients: N/A      Staff: Up to 2      Visitors: N/A
<b>Time of Use:</b>	Business hours (8.00am to 5.00pm).
Construction and Finishes	
<b>Floors:</b>	Sheet vinyl.      Skirtings: Vinyl covered 150.
<b>Walls:</b>	Flush plasterboard.
<b>Ceiling:</b>	Acoustic.      Height: 2700
<b>Doors:</b>	Solid core with half glass viewing pane.
<b>Door Hardware:</b>	Lockable with free handle exit, door stop.
<b>Windows:</b>	Viewing panel into adjoining areas.
<b>Signage:</b>	Room identification.
Services and Environment	
<b>Lighting:</b>	Fluorescent.
<b>Power:</b>	GPO’s as required.
<b>Communications:</b>	Wall hung telephone / intercom.
<b>Gases:</b>	Compressed air, one outlet per bench unit.
<b>Sanitary Fixtures:</b>	Stainless steel sink unit, double bowl and double drainer, with plaster traps.
<b>Environmental Control:</b>	Air conditioning and ventilation.
<b>Acoustics:</b>	Acoustic ceiling.
Furniture and Equipment	
<b>Loose Furniture:</b>	N/A
<b>Built In Furniture:</b>	Bench unit with acid resistant laminate top and underbench cupboards and drawers. Maxi-bin storage system. Provide built-in extraction system.
<b>Equipment / Fittings:</b>	Polishing machines Vice Steam cleaner Ultrasonic cleaner Chrome equipment (vacuum mixer). Soap dispenser Paper towel dispenser

## Room Data Sheet – Clean Room

Functional Information	
<b>Functions:</b>	Decontamination of completed work, packing of work for outside clinics and collection point for clinicians
<b>Relationship:</b>	Locate adjacent Laboratory entrance and Dental Technician's Workspace.
<b>Floor Area:</b>	6m <sup>2</sup>
<b>Occupants:</b>	Patients: N/A      Staff: Up to 2      Visitors: N/A
<b>Time of Use:</b>	Business hours (8.00am to 5.00pm).
Construction and Finishes	
<b>Floors:</b>	Non-slip vinyl sheeting.      Skirtings: Vinyl covered 150.
<b>Walls:</b>	Flush plasterboard.
<b>Ceiling:</b>	Acoustic.      Height: 2700
<b>Doors:</b>	Solid core with half glass viewing pane.
<b>Door Hardware:</b>	Lockable with free handle exit, door stop.
<b>Windows:</b>	Viewing panel into adjoining areas.
<b>Signage:</b>	Room identification.
Services and Environment	
<b>Lighting:</b>	Fluorescent.
<b>Power:</b>	GPO's as required.
<b>Communications:</b>	Wall mounted telephone / intercom.
<b>Gases:</b>	Compressed air.
<b>Sanitary Fixtures:</b>	Stainless steel sink with retractable hand held spray nozzle for rinsing. Milton bath for decontamination.
<b>Environmental Control:</b>	Air conditioning and ventilation.
<b>Acoustics:</b>	N/A
Furniture and Equipment	
<b>Loose Furniture:</b>	N/A
<b>Built In Furniture:</b>	Stainless steel bench with underbench storage units. Adjustable wall shelving.
<b>Equipment / Fittings:</b>	Maxi-bin storage system. Soap dispenser. Paper towel dispenser. Glove dispenser.

Indicative Plan

