



5 Design Recommendations – General Areas

Design recommendations for general areas are outlined in this section. General areas are those which enhance the functionality of health services, but are not critical, or specific to oral health facilities.

Areas which are identified in this section are those that can largely be shared by collocated health services. With the exception of the orthopantomograph x-ray, the design requirements for these are standard across oral and other health services. As such, no discussion regarding functionality or other details is provided.

Entry

Room Data Sheet

Functional Information	
Functions:	The main entrance to the dental facility, which should provide an easily found and welcoming atmosphere.
Relationship:	A porch, verandah or covered porte cochere opening to the waiting area.
Floor Area:	8 m ² (Covered space for reception of ambulant, wheelchair patients, prams and an occasional stretcher patient.
Occupants:	Patients: 2 or 3 Staff: Visitors:
Time of Use:	Business hours (8.00am to 5.00pm).
Construction and Finishes	
Floors:	Externally: Slip resistant hard wearing tiles. Mat well (drained if exposed to weather). Internally: Carpet tiles. Skirtings: N/A Flat vinyl
Walls:	Glass entry doors, and side-lights with midrail
Ceiling:	9mm FC set flush. Height: 2700mm
Doors:	Pair of aluminium framed automatic sliding doors – glass with mid-rails. Width 1800mm, height 2400mm.
Door Hardware:	Switched and keyed automatic doors.
Windows:	Side light windows with mid-rails on either side of door, with easy view to Reception and Waiting.
Signage:	Project specific external signs – Hosplan or Qld Health equivalent.
Services and Environment	
Lighting:	Externally: Energy efficient downlights. Internally: Fluorescent.
Power:	Power connection to automatic doors.
Communications:	N/A
Gases:	N/A
Sanitary Fixtures:	N/A
Environmental Control:	N/A
Acoustics:	N/A
Furniture and Equipment	
Loose Furniture:	N/A
Built In Furniture:	ww
Equipment / Fittings	Recessed doormat.

Indicative Plan



LEGEND
 ASD AUTOMATIC SLIDING DOORS (1500 WIDE)
 SRT..... SLIP RESISTANT TILES

Patient Waiting

Room Data Sheet

Functional Information	
Functions:	Area for consumers (adults & children) awaiting treatment or appointments
Relationship:	Direct access to Reception and Entry. Easy access to dental surgeries. Access to toilet facilities
Floor Area:	23 m ² + 1.75 m ² / additional consumer
Occupants:	Patients: 12 Staff: Visitors:
Time of Use:	Business hours (8.00am to 5.00pm)
Construction and Finishes	
Floors:	Carpet tiles. Skirtings: Flat vinyl.
Walls:	13mm plasterboard (with chair rail).
Ceiling:	Acoustic ceiling. Height: 2700mm
Doors:	Exterior: Refer Entry Interior: Solid core (1/2 glass panel, as required). 11/2 doors to surgery entrance.
Door Hardware:	Key card or digital pad locks to secure areas. Door closer.
Windows:	Aluminium framed (openable) with 1000mm sill.
Signage:	Project specific – Hosplan or Qld Health equivalent.
Services and Environment	
Lighting:	Fluorescent.
Power:	GPO's as shown.
Communications:	MATV outlet.
Gases:	N/A
Sanitary Fixtures:	N/A
Environmental Control:	Air conditioned.
Acoustics:	Low level background noise.
Furniture and Equipment	
Loose Furniture:	Visitor's chairs, coffee tables.
Built In Furniture:	N/A
Equipment / Fittings:	Television on wall or ceiling bracket Bottle water fountain with disposable cups. Notice boards Pamphlet rack Clock

Indicative Plan

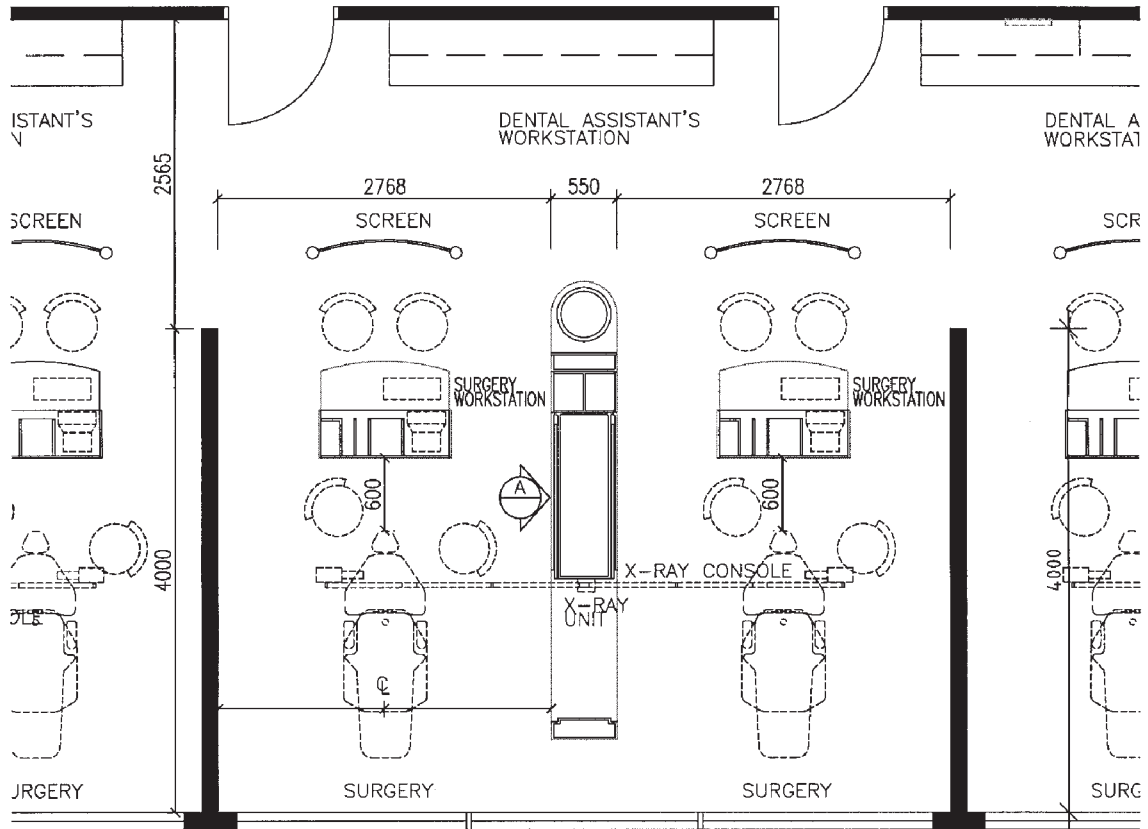

LEGEND	
T	DATA OUTLET TELEPHONE / INTERCOM
▼	DOUBLE GENERAL PURPOSE OUTLET
CT	COFFEE TABLE
NB	NOTICE BOARD
PR	PAMPHLET RACK
WF	WATER FOUNTAIN
TB	CHILDREN'S TOYBOX
⦶	MATV OUTLET

Indicative Plan

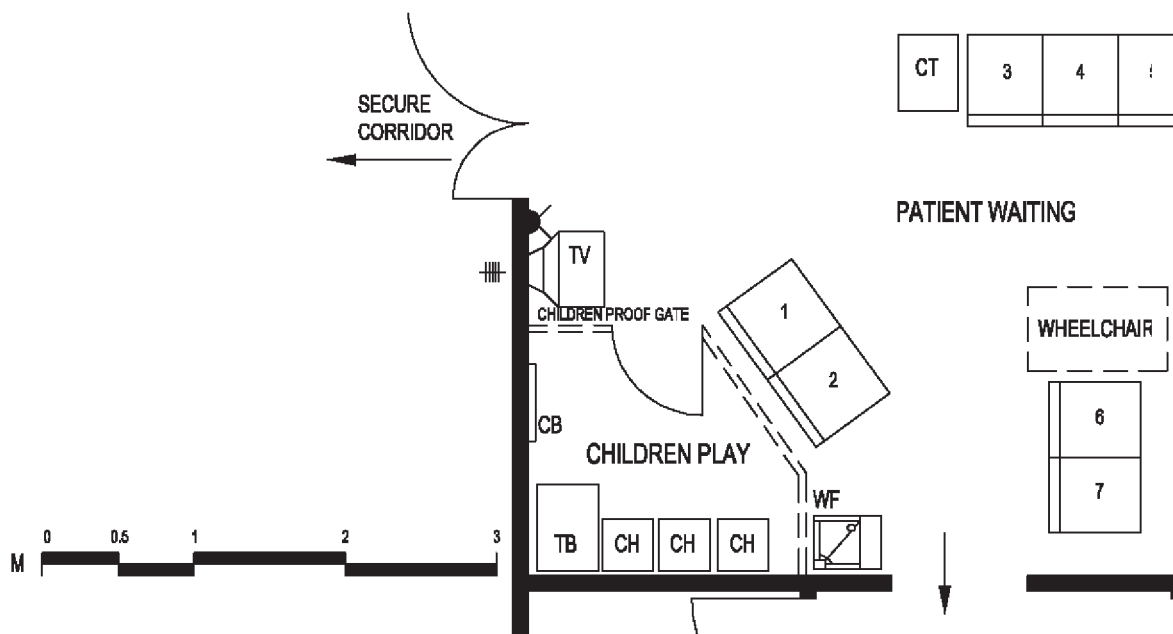

LEGEND	
TB.....	TOY BOX
CB	CHALK BOARD
CH	CHILDREN'S CHAIRS

Reception

Room Data Sheet

Functional Information			
Functions:	Office area associated with reception of consumers, appointment making and general office activities.		
Relationship:	Direct access and view to Entry and Waiting. Contiguous with General Office and Records. Situates close to main circulation routes.		
Floor Area:	1 ² m ² + 2 m ² /fte		
Occupants:	Patients:	Staff: 2	Visitors:
Time of Use:	Business hours (8.00am to 5.30pm).		
Construction and Finishes			
Floors:	Carpet tiles.	Skirtings:	Flat vinyl.
Walls:	13mm plasterboard flush set.		
Ceiling:	Acoustic ceiling.	Height:	2700mm
Doors:	Solid core.		
Door Hardware:	Door to Waiting: Locked from waiting side with free handle exit to reception, door stop. No door between Reception and General Office.		
Windows:	External: Aluminium framed. Internal: Reception counter – security glass and roller grille.		
Signage:	Reception to be clearly signposted.		
Services and Environment			
Lighting:	Fluorescent.		
Power:	GPO's as shown.		
Communications:	Telephone / intercom. Data outlets as shown. Duress alarm.		
Gases:	N/A		
Sanitary Fixtures:	N/A		
Environmental Control:	Air conditioning.		
Acoustics:	Low echo environment for confidential discussion with consumers.		
Furniture and Equipment			
Loose Furniture:	Office chairs, waste bins.		
Built In Furniture:	2 x workstations, wall shelving. Reception desk which allows form filling by standing, seated & disabled (wheelchair) consumers on one side, and clerical staff on the other. Refer AS 1428.		
Equipment / Fittings:	Computers, battery clock.		

Indicative Plan

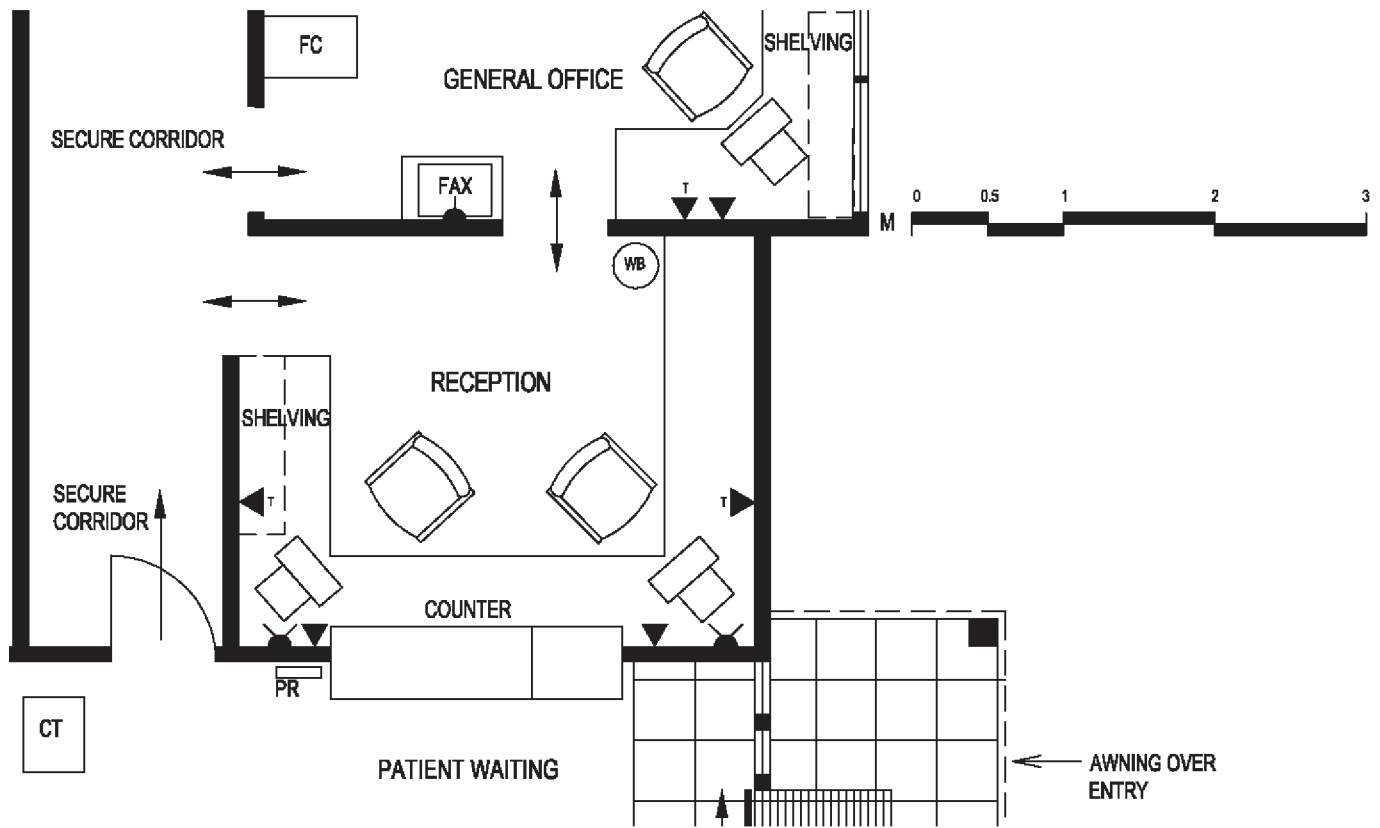

LEGEND	
TTELEPHONE / INTERCOM WALL HUNG
◼DOUBLE GENERAL PURPOSE OUTLET
PHPHOTOCOPIER / PRINTER
WBWASTE BIN
▼DATA OUTLET

Indicative Plan

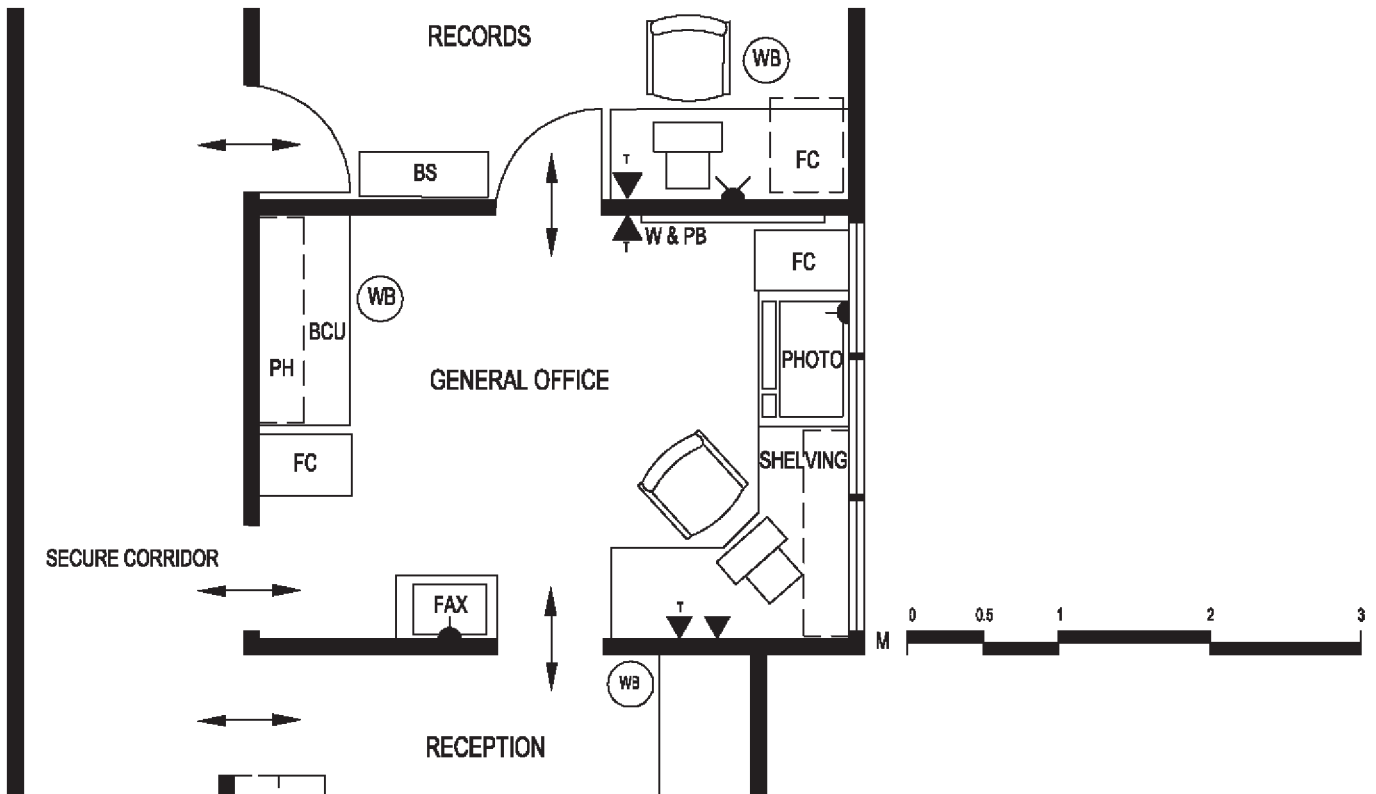

LEGEND	
TTELEPHONE / INTERCOM WALL HUNG
▼GENERAL PURPOSE OUTLET
FCFILING CABINET
PHOTOPHOTOCOPIER
WBWASTE PAPER BIN
PHPIGEON HOLES OVER
BCUBENCH WITH CUPBOARDS UNDER

Records

Room Data Sheet

Functional Information

Functions:	Storage of active clinical records (minimum of 2 years).		
Relationship:	Direct access to General Office, Reception and secure corridor.		
Floor Area:	20 m ²		
Occupants:	Patients:	Staff: 1	Visitors:
Time of Use:			

Construction and Finishes

Floors:	Carpet tiles.	Skirtings:	Flat vinyl.
Walls:	13mm plasterboard.		
Ceiling:	10mm plasterboard flush set.	Height:	2700mm
Doors:	Solid core		
Door Hardware:	Lockable with free handle exit, doorstop.		
Windows:	Not required.		
Signage:	Room identification.		

Services and Environment

Lighting:	Fluorescent.
Power:	GPO's as indicated.
Communications:	Telephone / intercom. Data outlet as shown.
Gases:	N/A
Sanitary Fixtures:	N/A
Environmental Control:	Air conditioning.
Acoustics:	N/A

Furniture and Equipment

Loose Furniture:	Record storage – metal shelves or compactus. Office chair, filing cabinet, waste paper bin.
Built In Furniture:	1 x workstation, book shelves.
Equipment / Fittings:	Computer.

Indicative Plan

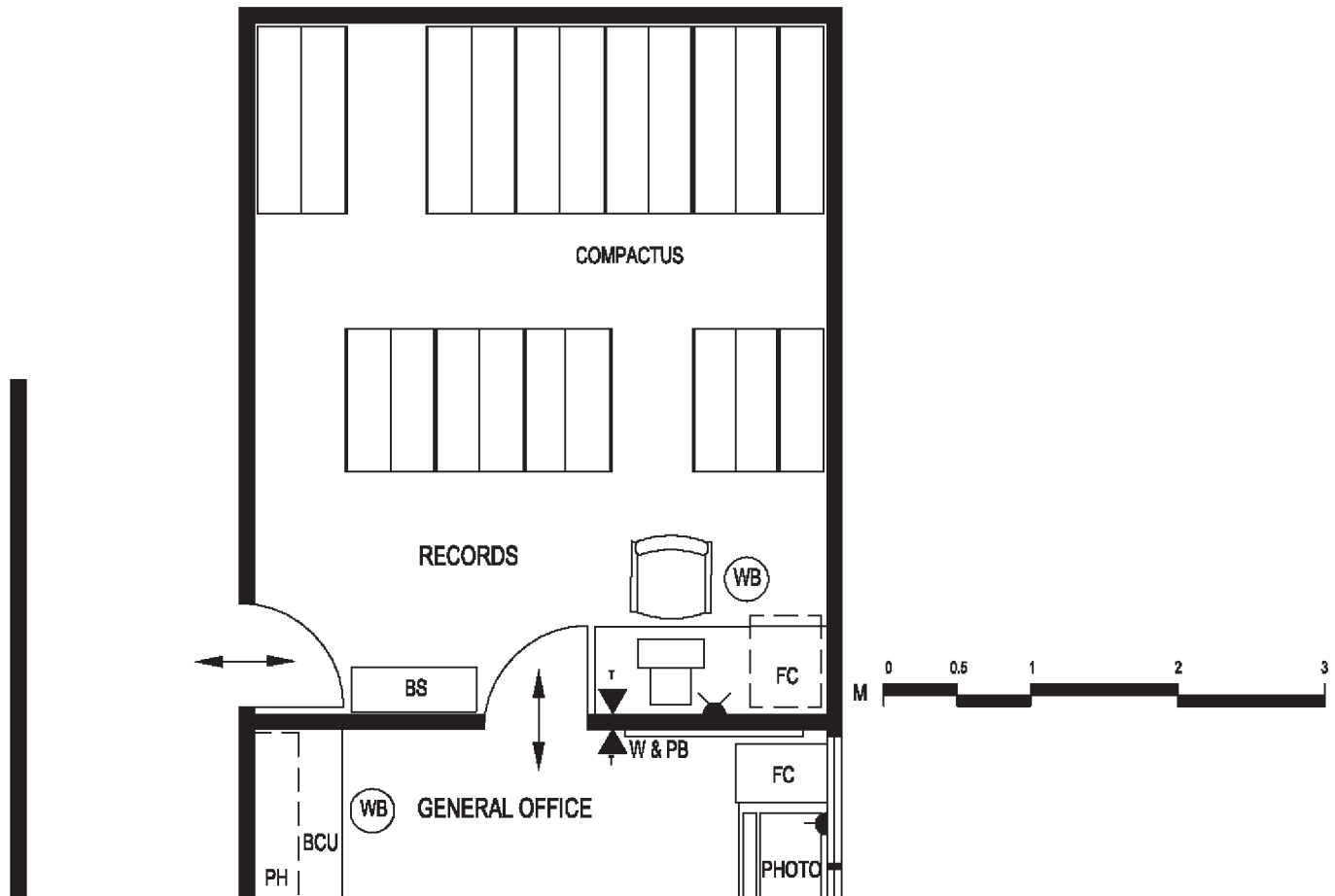

LEGEND	
TDATA OUTLET TELEPHONE / INTERCOM
▼DOUBLE GENERAL PURPOSE OUTLET
FCFILING CABINET
WBWASTE PAPER BIN
BSBOOKSHELVES (1800MM HEIGH)